

# The Grace Vine

✚ GRACE  
EPISCOPAL CHURCH & SCHOOL



## WHO WE ARE



We are a multi-cultural, multi-racial, and multi-generational congregation. We find joy and meaning in our shared Episcopal tradition, while honoring our diversity.

Our mission is to live out the unconditional and reconciling love of God with generous hospitality, inspired worship, and inclusive community.



## WHAT WE ARE ALL ABOUT

# OUR CORE VALUES

## ➤➤➤ COMMUNION - COMMON PRAYER, COMMON LIFE

We come together not based on intellectual uniformity or shared interest, but, first and foremost, because of the radical hospitality of Christ who calls us to gather around a common table. We share in communion together, no matter how we may be different or disagree with one another.

**WE WELCOME  
EVERYONE**



## ➤➤➤ COMPASSION - ALL ARE LOVED, ACCEPTED, CARE FOR

We desire to be authentic people, not putting on airs or pretense to cover up the truth of who we are. We want to welcome everyone. We also desire to care for our community, especially those who are aging, infirm, marginalized or oppressed. We uphold our baptismal vows to respect the dignity of every human being, and seek and serve Christ in one another.



## ➤➤➤ COLLABORATION - A PLACE FOR EVERYONE

We value the kind of interactions that encourage the best in one another. We want to call out that goodness for the sake of our life together. We each bring all that we are and know and have, and offer it for the good of one another. We value the kind of leadership that holds space for all voices to be heard and helps all to contribute their gifts for the blessing and benefit of the community.



## ➤➤➤ CREATIVITY - BEYOND BOUNDS

God is creative, and we are made in God's image as creative beings. As a vital church, we are constantly growing, changing, and adapting. We do not want to be stuck in old or established ways of being, knowing, or doing that keep us from moving forward together into God's future. We value creativity, and we desire to embrace imagination, vision and risk-taking together.

## ➤➤➤ COMMISSION - GOING OUTSIDE, GOING TOGETHER

**WE DO THE  
WORK  
TOGETHER**

God sends us out as ambassadors of Grace into the world. We are not blessed only for ourselves, but that others may be blessed through us. We do the work together, in partnership with God and each other.

# OUR VISION

- ★ Grace Episcopal Church is a Christ-centered community of people from diverse walks of life, cultures, languages, religious backgrounds, identities, sexual orientations, and faith experiences.
- ★ Our life together is grounded in the tradition of The Episcopal Church.
- ★ We say we are “Christ-Centered” because at the heart of our life together is a desire to follow the person, example and teachings of Jesus Christ.







Originally, two Episcopal churches were established in our area: St. George's in 1958 and St. Patrick's in 1959. They came together in 1985 to form a new church. We were officially called St. George and St. Patrick's Episcopal Church, but our nickname was "Two Saints."



In 2010, we undertook a new name to reflect the work of God among us: Grace. It was at this time that we moved from a parish to a mission of the Diocese of Texas. We worked hard to grow through a number of efforts including the debut of "yoga mass", outreach and virtual services during the COVID-19 pandemic, professional concerts, and the debut of the Spanish service in 2022. Over time, we became known as a multi-ethnic, intergenerational church with a vibrant music ministry and a thriving day school.



After years of uncertainty about our future, Grace is now a growing congregation. We became an independent parish again in 2022, ringing the bell at the annual Diocesan Council meeting and ushering in a new season of hope. The movement back to a parish status is a rarity and demonstrates the strength of the congregation's desire to move the church forward.



Throughout the history of the church, a constant thread has always been that we are an inclusive, multi-cultural community.

# CHURCH COMMUNITY

## ➤➤➤ WORSHIP

We come together to be encouraged and transformed in worship. We sing many different styles of music including hymns, Gospel, jazz, and chants - representing the rich diversity of our church.

### Sundays:

Rite II Eucharist (English), 10 am  
In-person and streamed online

La Misa (Español), 12 pm  
Officiated by Padre Montes

### Thursdays:

Contemplative Prayer, 5 pm



## ➤➤➤ SPECIAL SERVICES

Various musical performances involving the surrounding community include: Brubeck Jazz Mass for Hope in October 2022, Scott Joplin Chamber Orchestra performance for Dr. Martin Luther King Jr.'s Birthday 2023

### Yearly Celebrations

The Longest Night Service  
Stations of the Cross on Good Friday  
Blessing of the Backpacks  
Pre-K Graduation  
Blessing of the Pumpkins





## ➤➤➤ WORSHIP MINISTRIES AND SERVICE



Altar Guild and Flower Guild

- Healing Ministries
- Ushers & Counters
- Children's Chapel
- Hospitality



Vestry



Lectors &  
Prayer Leaders



Verger & Acolytes



Lay Eucharistic Ministers



## ➤➤➤ PARISH LIFE

- Daughters of the King (DOK)
- Contemplative Prayer Book Group
- Grace at Lunch
- Healing Prayer Team
- Men of Grace with weekly Zoom and monthly breakfast
- Women's Group with weekly Zoom
- Young-ish Group - monthly get-together of <50-year-olds
- Jam Night





## ➤➤➤ ANNUAL ACTIVITIES

- DOK Retreats in the Spring and Fall
- Interfaith Dance on the Labyrinth
- DOK Chrismon Tree Trimming
- Property Clean-Up Workdays
- Shrove Tuesday Pancake Supper
- Spring Cream Tea
- Christmas Tea
- Interfaith Iftar
- Newcomers' Dinner
- Easter Egg Hunt
- Stations of the Cross
- Hispanic Heritage celebration





## COMMUNITY CONNECTIONS



- Community Garden
- Braes Interfaith Ministries (BIM)
  - Leadership on the Board
  - Monthly donations
- Frequent blood drives
- Grace2Go Bags - Food/toiletries
- ESL class - to launch in Jan. 2024
- PRIDE parade
- Pumpkin Patch
- History of sharing our space with other denominations and faiths (Lutheran, Jewish, etc.)
- Weekly Alcoholics Anonymous Meetings

## FAITH FORMATION

Children:

- Children's Chapel, ages 4-10
- Pray Ground: multi-sensory worship area in the back of the church for children of any age.

Adults:

- Sunday School with rotating leaders and seasonal book and Bible studies





## ➤➤➤ PARISH SCHOOL

Grace Episcopal School is a community of compassionate, curious students where each child is nurtured in a structured, joyful, and secure environment. We celebrate the human spirit and honor the diversity among us while fostering the love of learning, creativity, and wonder. The school has been in operation for over 25 years as a licensed day school.

*The school currently has an enrollment of 85 students and employs 20 teachers, of which half are native Spanish speakers. Our school is the only facility in the area that accepts children as young as 6 weeks old.*

Our school board of directors is comprised of members of the Vestry, church members, and school parents. The church rector serves as the board chair and is seated on the executive committee along with a vice president, treasurer, and secretary. Monthly board meetings include standing reviews of the school's finances and status of the school and discussion on topics that continue to move the school forward in education and spirituality.



# OUR FACILITY

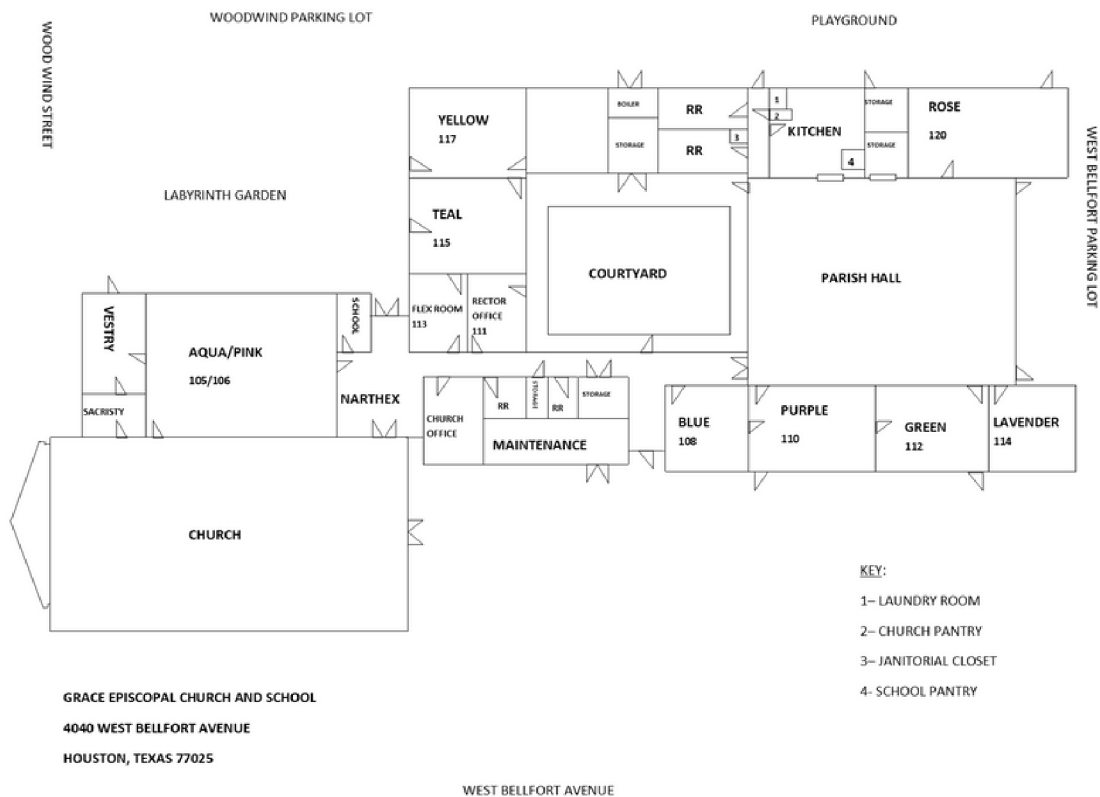



# OUR NUMBERS

## MEMBERSHIP DEMOGRAPHICS

Total Active Baptized Members	138
Average Sunday Attendance	111

Age	Number	Percentage
Children (ages 0-12)	24	17%
Youth (ages 13-17)	8	6%
Young adults (ages 18-34)	21	15%
Middle adults (35-64)	35	26%
Senior adults (ages 65 and older)	50	36%
	138	100%

## FINANCIAL HIGHLIGHTS

	2022 Actual	2023 Budget
Pledge and Plate Receipts	\$206,708	\$181,100
Total All Revenues	\$338,292	\$365,224
Total All Expenses	\$337,229	\$363,250

# OUR “HOLY COW” SURVEY RESULTS

Morale

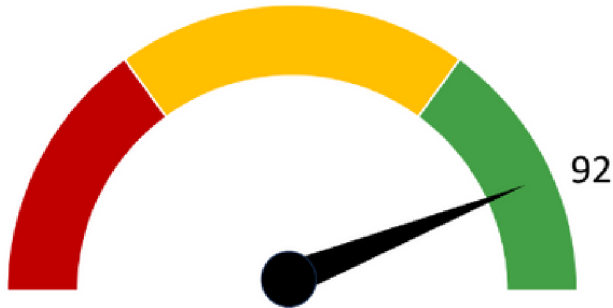

Conflict Management

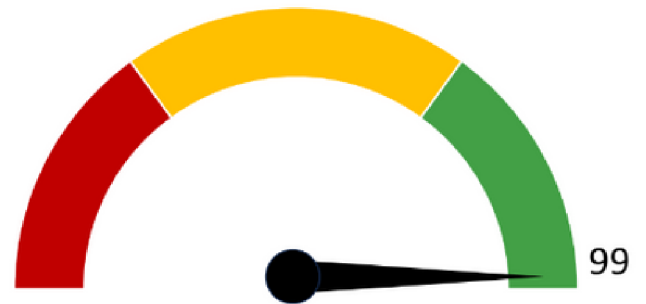

Governance

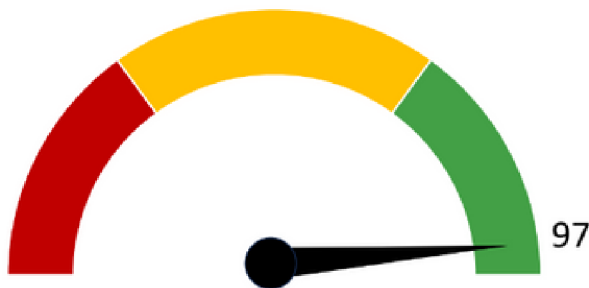

Spiritual Vitality



Readiness for Ministry



SEE [WWW.GRACEINHOUSTON.ORG/RECTOR-SEARCH.HTML](http://WWW.GRACEINHOUSTON.ORG/RECTOR-SEARCH.HTML)  
FOR MORE DETAILS





# WHAT WE'RE LOOKING FOR

15

## ➤➤➤ NEW RECTOR PROFILE

We seek a rector who can develop and implement a comprehensive strategy to reach new people and incorporate them into the life of the church. Specifically, we would love to see more families with children and youth involved in our congregation. This might also require us to enlarge or improve the physical facilities of the church as we expand or enhance our ministries.

With those goals, we know we need a rector with strong program planning, stewardship, and management skills. We also want a collaborative leader with gifts for empowering and equipping lay people for ministry. We are in the process of expanding our outreach ministries to provide direct services to those living on the margins of society. Our rector should share that focus. Currently, our outreach committee is working to launch ESL classes, and our Spanish language service is growing. Bi-lingual (Spanish) is preferred but not required.

Our diverse community requires someone with competency and comfort working in a multiracial, multicultural context. We need a rector with the ability to cultivate relationships with multiple generations and backgrounds. We hope to find someone who shares our progressive, adaptable theological perspective.



## ➤➤➤ NEW RECTOR PROFILE - CONTINUED

In addition, we would love for our church to provide more opportunities for Christian education and spiritual formation at every age and stage of life. We also need a decisive leader who can manage both the Church and School while being approachable and collaborative. A rector with a heart for teaching and a strong administrative background would be very helpful as well as having compassion towards staff, children, and parents.

Since hospitality is one of our highest values, we seek someone who models this. Being authentically friendly and engaging with people from all walks of life is essential, as is the ability to communicate in honest and thoughtful ways. Grace would welcome an imaginative spiritual leader who seeks innovation while respecting tradition and embraces technology in a creative way. We commit to helping one another as needed, and we do so with joy, music, and love.

**WE'RE PRAYING FOR YOUR WISDOM AND DISCERNMENT**





# WELCOME TO HOUSTON!

Houston is a large metropolis in Texas and has been described as the most racially and ethnically diverse major city in the United States.

## ➤➤➤ NEARBY ATTRACTIONS

Located in the Meyerland area of Southwest Houston, Grace Episcopal Church is minutes away from many Houston attractions and venues including:

NRG Park- home to the Houston Texans and Houston Livestock Show & Rodeo

Minute Maid Park- home to the World Champion Houston Astros

Toyota Center- home to the Houston Rockets and a popular concert venue

Houston Museum District- home to 20 museums and venues including:

Houston Museum of Natural History

Rothko Chapel

Children's Museum of Houston

The Menil Collection

Museum of Fine Arts, Houston

Holocaust Museum

Houston Zoo

Miller Outdoor Theatre

Hermann Park

Hermann Park Golf Course

Memorial Park - a favorite place for walkers and joggers which also includes the Houston Arboretum and Nature Center and one of the top municipal golf courses in the nation.

Galleria Shopping Center- known for its luxurious shopping experience.

Downtown Houston - home to Fortune 500 companies including Kinder Morgan, NRG Energy, CenterPoint Energy, and Waste Management.

Texas Medical Center- the world's largest medical center including world-renowned Texas Children's Hospital, MD Anderson Cancer Center, and many other hospitals and research institutions.

## ➤➤➤ LOCAL SCHOOLS

There are four schools within walking distance of the church:

Shearn Elementary is a public school in the Houston Independent School District serving grades Pre-Kindergarten through 5th grade. The school is a dual-language campus, offering English and Spanish instruction.

Corpus Christi Catholic School is a private school serving grades Pre-Kindergarten 3 through 8th grade. Founded in 1959, the school is accredited by the Texas Catholic Conference of Bishops Education Department.

The Emery/Weiner School is a Jewish private college-preparatory school serving 6th through 12th grade.

Willow Meadows Day School provides daycare services for children 5 months of age - Pre-Kindergarten. The day school is a mission of Willow Meadows Baptist Church and is a member (like our church) of Braes Interfaith Ministry.

## ➤➤➤ COLLEGES AND UNIVERSITIES

The following institutions of higher learning are located within 10 miles of our church:

University of Houston

Rice University

University of St. Thomas

Houston Community College

Texas Woman's University

Houston Christian University

Texas Southern University

Baylor College of Medicine

University of Texas Health



## ➤➤➤ HOW TO FIND US

Grace Episcopal Church and School  
4040 W. Bellfort Ave  
Houston, TX 77025  
832-667-8601  
office@graceinhouston.org

[www.graceinhouston.org](http://www.graceinhouston.org)  
[www.facebook.com/GraceinHouston](https://www.facebook.com/GraceinHouston)  
[www.youtube.com/graceinhouston](https://www.youtube.com/graceinhouston)  
[www.instagram.com/grace\\_in\\_houston](https://www.instagram.com/grace_in_houston)  
[www.graceinhouston.school.org](http://www.graceinhouston.school.org)

[www.graceinhouston.org/rector-search.html](http://www.graceinhouston.org/rector-search.html)

